

Portable EV Charger

AC 240V 7.68KW MAX NEMA 14-50 Plug



PRODUCT SPECIFICATIONS

Voltage	400V AC 3-phase
Current	16A Max
Power	11.04 kW Max
Plug	CEE 5 Pin Plug
Standard	IEC 62196-2 / Type 2
Operating Temperature	-30°C to 50°C
Storage Temperature	-40°C to 85°C
IP Rating	IP66
Total Length	7.8M

PRODUCT OVERVIEW

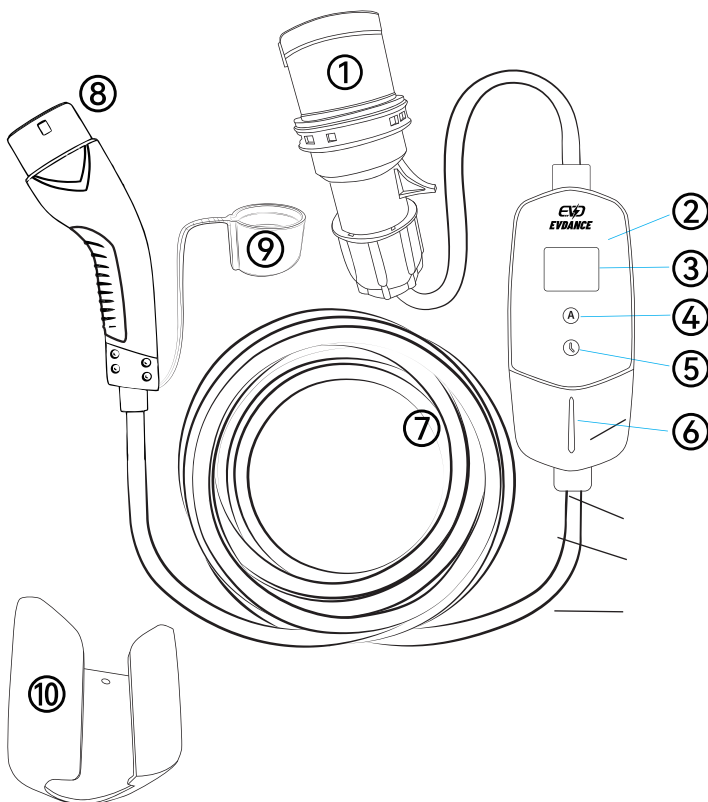

- ① CEE 5 Pin Plug
- ② Control Box
- ③ 2.4" TFT Display
- ④ Current Adjust Button
- ⑤ Delayed Start Timer Button
- ⑥ LED Light
- ⑦ Charging Cable
- ⑧ Type 2 Connector
- ⑨ Protective Cap
- ⑩ Control Box Holder

DISPLAY DESCRIPTION

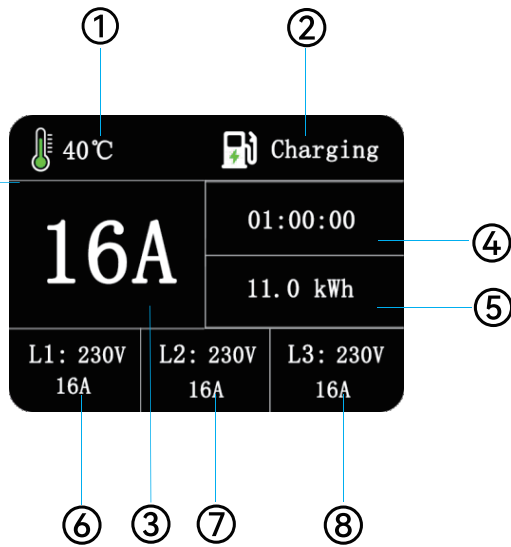

- ① Temperature
- ② Work Status
- ③ Charging Current
- ④ Charging Time
- ⑤ Electricity Consumption
- ⑥ L1 Voltage and Current
- ⑦ L2 Voltage and Current
- ⑧ L3 Voltage and Current

CONTACT INFORMATION



Tel: +86 19521075435



<http://ycckj.cn.alibaba.com>



Whatsapp: +86-18738585876



Email: contact@evdances.com

